

MW 6  
N. 1951273.316  
E. 6570265.931  
EL. 98.92

MW 5  
N. 1951239.560  
E. 6570252.902  
EL. 100.27

MW 3  
N. 1951244.652  
E. 6570247.866  
EL. 101.19

MW 1  
N. 1951219.402  
E. 6570287.849  
EL. 99.49

MW 2  
N. 1951193.695  
E. 6570261.854  
EL. 100.15

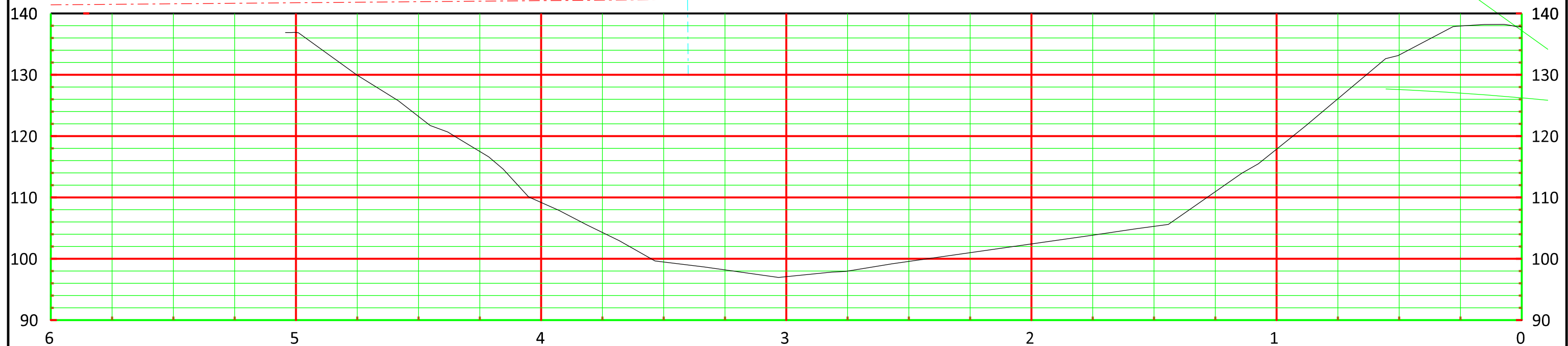
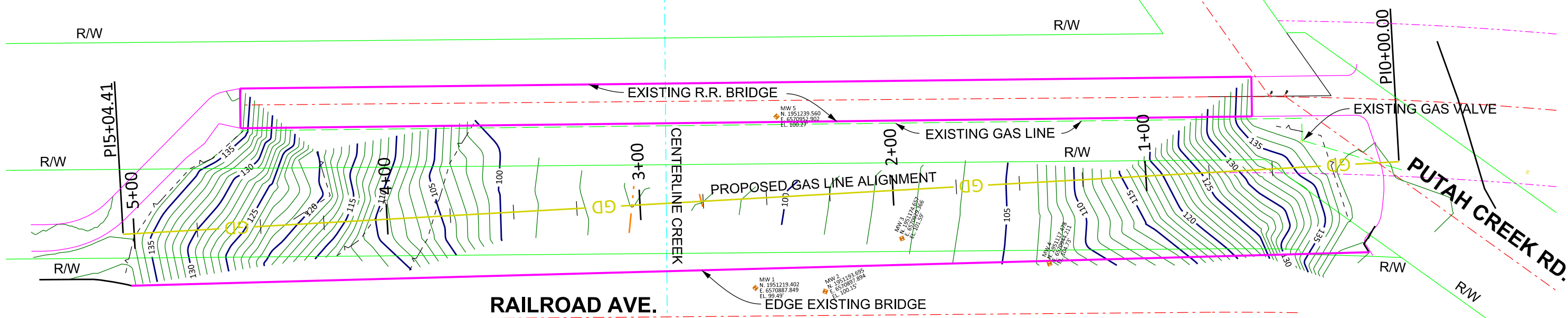

NO.	DATE	DESCRIPTION	SEARCH	SEC.	COMPS.	SEC.	F. B.	SEC.
REVISIONS								

APPROVED BY	PLAT# :
	SUPV. :
	DSGN. :
	DWN. : LEPH
	CHKD. :
	O.K. :
	DATE : 4/20/2020
	SCALES 1"=40'

## PUTAH CREEK TOPO AT RAILROAD AVE. FOR PROPOSED GAS LINE BORING

PACIFIC GAS AND ELECTRIC COMPANY

SEC	T.	R.
COUNTY : YOLO - SOLANO		
DIVISION : SACRAMENTO		
AUTH # : 35058161		
SHEET NO. 1	SHEETS 1	REV.