

Appendix B

Photometric Plan

ELECTRICAL CONTRACTOR & ENGINEER OF RECORD



SCHETTER ELECTRIC INCORPORATED
CONTRACTING & ENGINEERING
 471 Barron St. Sacramento Ca 95811
 Tel: 916.446.2521 Fax: 916.446.2621
 CA License #245778
 NV License #B-54463 #C2-54454
SCHETTER.COM



SEI #C13000
 THESE PLANS AND SPECIFICATIONS WERE PREPARED BY SCHETTER ELECTRIC, INC. IN ACCORDANCE WITH THE ELECTRICAL CONTRACTING AND ENGINEERING CODE, WHICH REGULATES THE PRACTICE OF ELECTRICAL CONTRACTING AND ENGINEERING. THE PRACTICE OF ELECTRICAL CONTRACTING AND ENGINEERING IS A PROFESSIONAL SERVICE AND THE PRACTICE OF THIS PROFESSIONAL SERVICE IS LIMITED TO THE PRACTICE OF ELECTRICITY AND ELECTRONICS IN THE STATE OF CALIFORNIA.

NOT FOR CONSTRUCTION

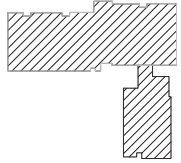
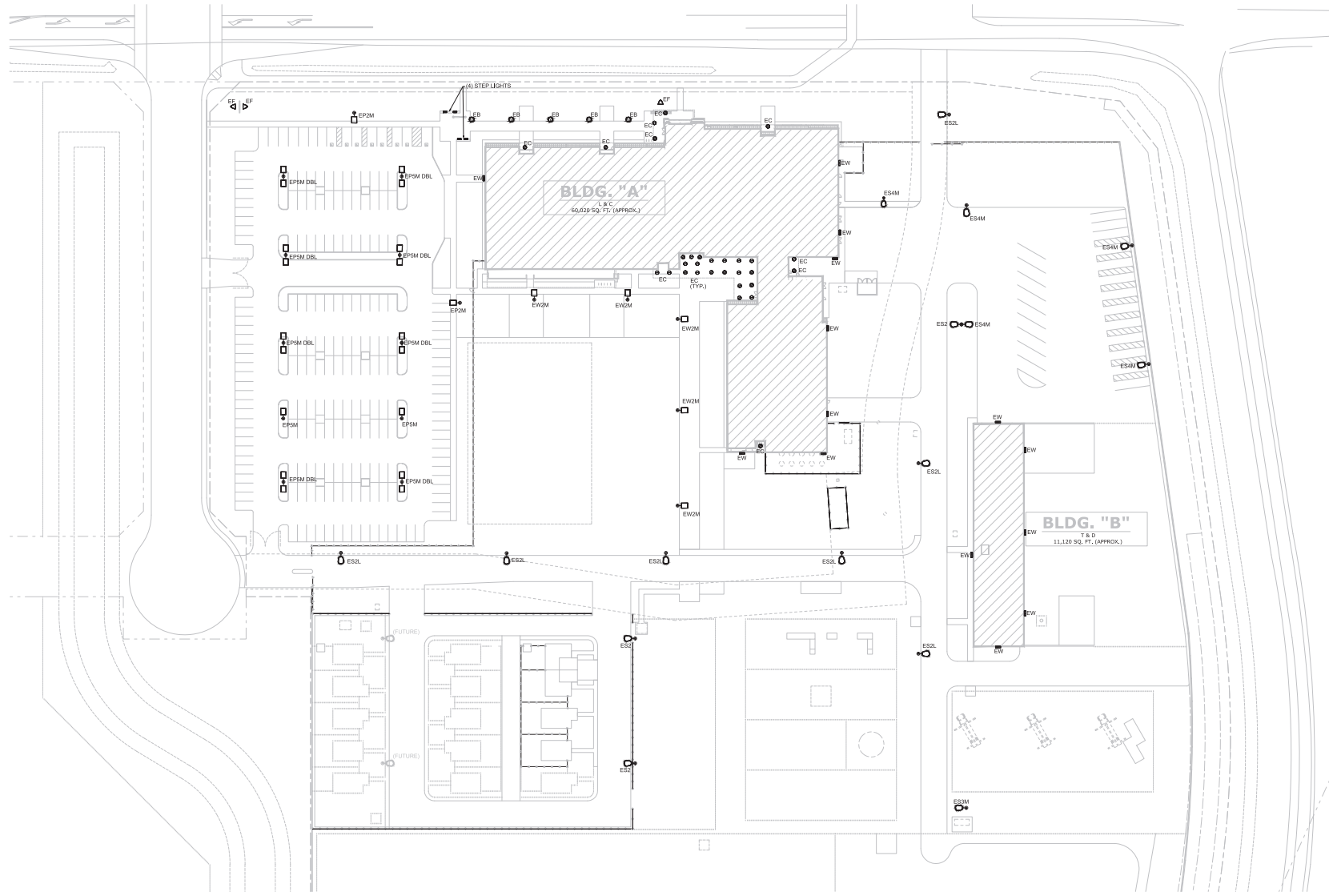

KEY PLAN

DESIGN DEVELOPMENT

REVISION	BY	DATE

PG&E
 PG&E Gas Operations
 Technical Training Center

SITE LIGHTING PLAN



ELECTRICAL CONTRACTOR & ENGINEER OF RECORD



SCHETTER ELECTRIC INCORPORATED
CONTRACTING & ENGINEERING
471 Barron St. Sacramento Ca 95811
Tel: 916.446.2521 Fax: 916.446.2621
CA License #245778
NV License #B-54633 #C2-54554
SCHETTER.COM



SEI #C13000
THIS PLAN AND ALL INFORMATION CONTAINED HEREIN ARE THE PROPERTY OF SCHETTER ELECTRIC, INC. IN ACCORDANCE WITH THE CONTRACT DOCUMENTS AND SPECIFICATIONS, NO PART OF THIS PLAN OR INFORMATION CONTAINED HEREIN IS TO BE REPRODUCED OR TRANSMITTED IN ANY FORM OR BY ANY MEANS, ELECTRONIC OR MECHANICAL, INCLUDING PHOTOCOPYING, RECORDING, OR BY ANY INFORMATION STORAGE AND RETRIEVAL SYSTEM, WITHOUT THE WRITTEN PERMISSION OF SCHETTER ELECTRIC, INC. THIS PLAN IS TO BE USED FOR THE PURPOSES OF RECORD OR REFERENCE IN ANY OTHER CONTRACT DOCUMENT.

NOT FOR CONSTRUCTION

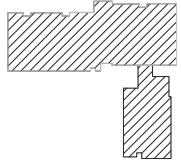

KEY PLAN

DESIGN DEVELOPMENT

REVISION BY DATE

PGICE
PGCE Gas Operations
Technical Training Center

SITE LIGHTING PHOTOMETRIC PLAN



83011.01
NO SCALE
Date: 03/30/2014
E1.3

Symbol	Label	Quantity	Details/Notes	Notes
○	BLRD	14	BLVD LIGHTING - 1" X 2" COMPACT RECESSED - 120V 50/60 HZ 1000 LUMEN (1000000)	2817
□	D	14	DRIVE LIGHTS - 1" X 2" COMPACT RECESSED - 120V 50/60 HZ 1000 LUMEN (1000000)	2817
◻	EW	14	EMERGENCY WALKWAY LIGHTING - 1" X 2" COMPACT RECESSED - 120V 50/60 HZ 1000 LUMEN (1000000)	4317
◻	EWZM	2	EMERGENCY WALKWAY LIGHTING - 1" X 2" COMPACT RECESSED - 120V 50/60 HZ 1000 LUMEN (1000000)	4317
◻	EPMDRL	2	EMERGENCY PARKING LIGHTING - 1" X 2" COMPACT RECESSED - 120V 50/60 HZ 1000 LUMEN (1000000)	2817
◻	EPZM	2	EMERGENCY PARKING LIGHTING - 1" X 2" COMPACT RECESSED - 120V 50/60 HZ 1000 LUMEN (1000000)	100
◻	EPZM	2	EMERGENCY PARKING LIGHTING - 1" X 2" COMPACT RECESSED - 120V 50/60 HZ 1000 LUMEN (1000000)	100
◻	ES3M	1	EMERGENCY SIDE LIGHTING - 1" X 2" COMPACT RECESSED - 120V 50/60 HZ 1000 LUMEN (1000000)	100
◻	ES3L	1	EMERGENCY SIDE LIGHTING - 1" X 2" COMPACT RECESSED - 120V 50/60 HZ 1000 LUMEN (1000000)	100
◻	ES3	1	EMERGENCY SIDE LIGHTING - 1" X 2" COMPACT RECESSED - 120V 50/60 HZ 1000 LUMEN (1000000)	100
◻	ES4M	1	EMERGENCY SIDE LIGHTING - 1" X 2" COMPACT RECESSED - 120V 50/60 HZ 1000 LUMEN (1000000)	100

Statistics

Description	Avg	Max	Min
DRIVE - BACKSIDE	2.4 fc	5.1 fc	0.6 fc
DRIVE - EAST SIDE - 1FC MIN	2.5 fc	5.7 fc	0.8 fc
FUELING AREA	3.5 fc	5.8 fc	1.7 fc
MAIN PARKING LOT	2.5 fc	8.9 fc	0.5 fc
PARKING - EAST SIDE - INSTRUCTIONAL	1.1 fc	7.7 fc	0.2 fc
WALKWAY - EAST SIDE - BACK	4.8 fc	16.8 fc	0.1 fc
WALKWAY - EAST SIDE - FRONT	2.7 fc	10.4 fc	0.2 fc
WALKWAY - GSR - BACK	2.5 fc	5.8 fc	0.6 fc
WALKWAY - WEST SIDE - BACK	1.6 fc	5.8 fc	0.4 fc
WALKWAY - WEST SIDE - FRONT	1.7 fc	6.0 fc	0.8 fc
WALKWAY BACK CENTER	2.5 fc	3.8 fc	1.4 fc
WALKWAY CENTER BACK	2.1 fc	5.6 fc	0.1 fc

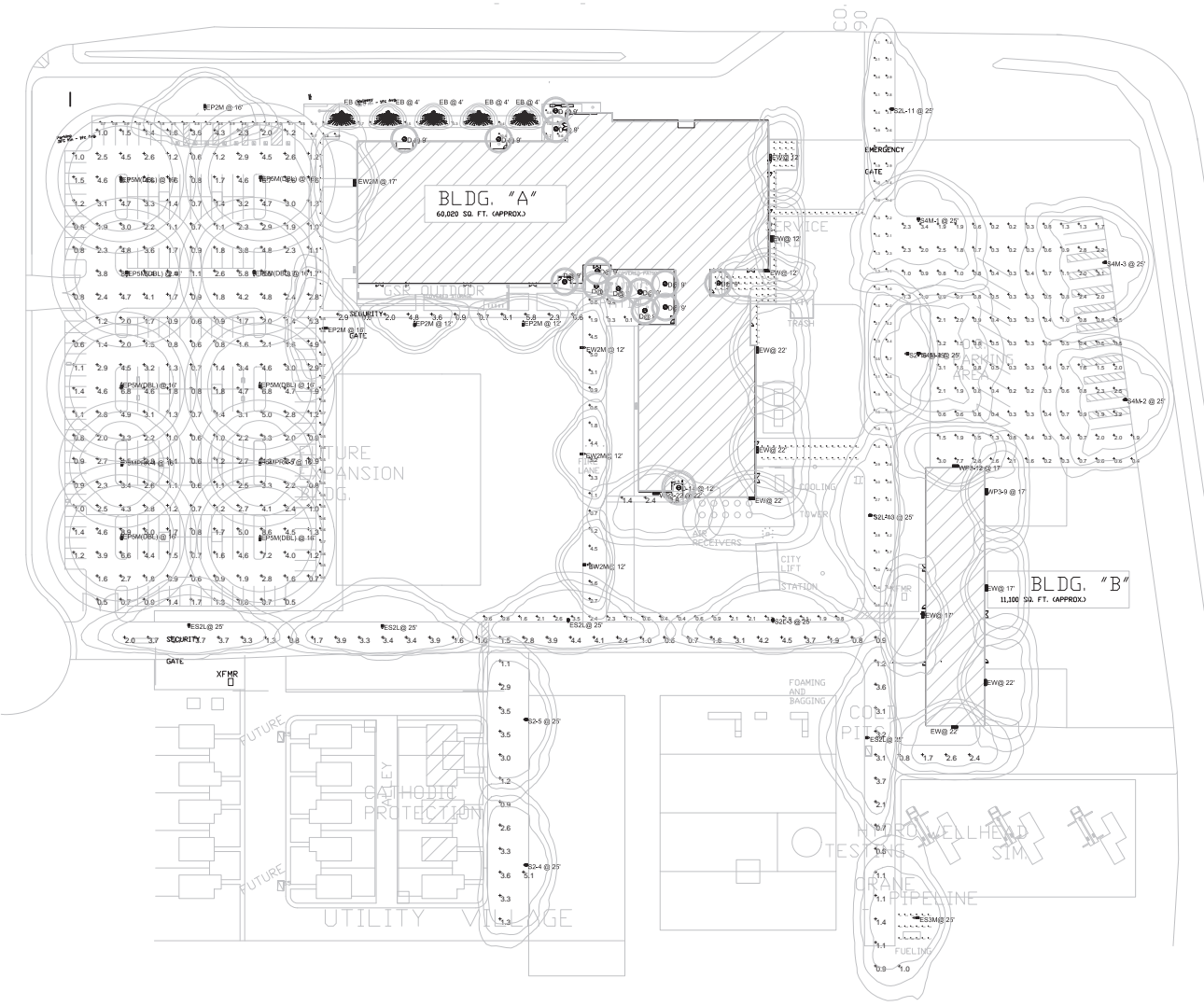

SITE LIGHTING PHOTOMETRIC PLAN
1" = 40'-0" SCALE
E1.3